

BL Update

Embracing a changing world

Kate Ebdon

Customer Liaison & Corporate
Feedback Manager

British Library locations



Boston Spa
Yorkshire

St Pancras
London



BRITISH LIBRARY

Living Knowledge



We make our intellectual heritage accessible to everyone for research, inspiration and enjoyment

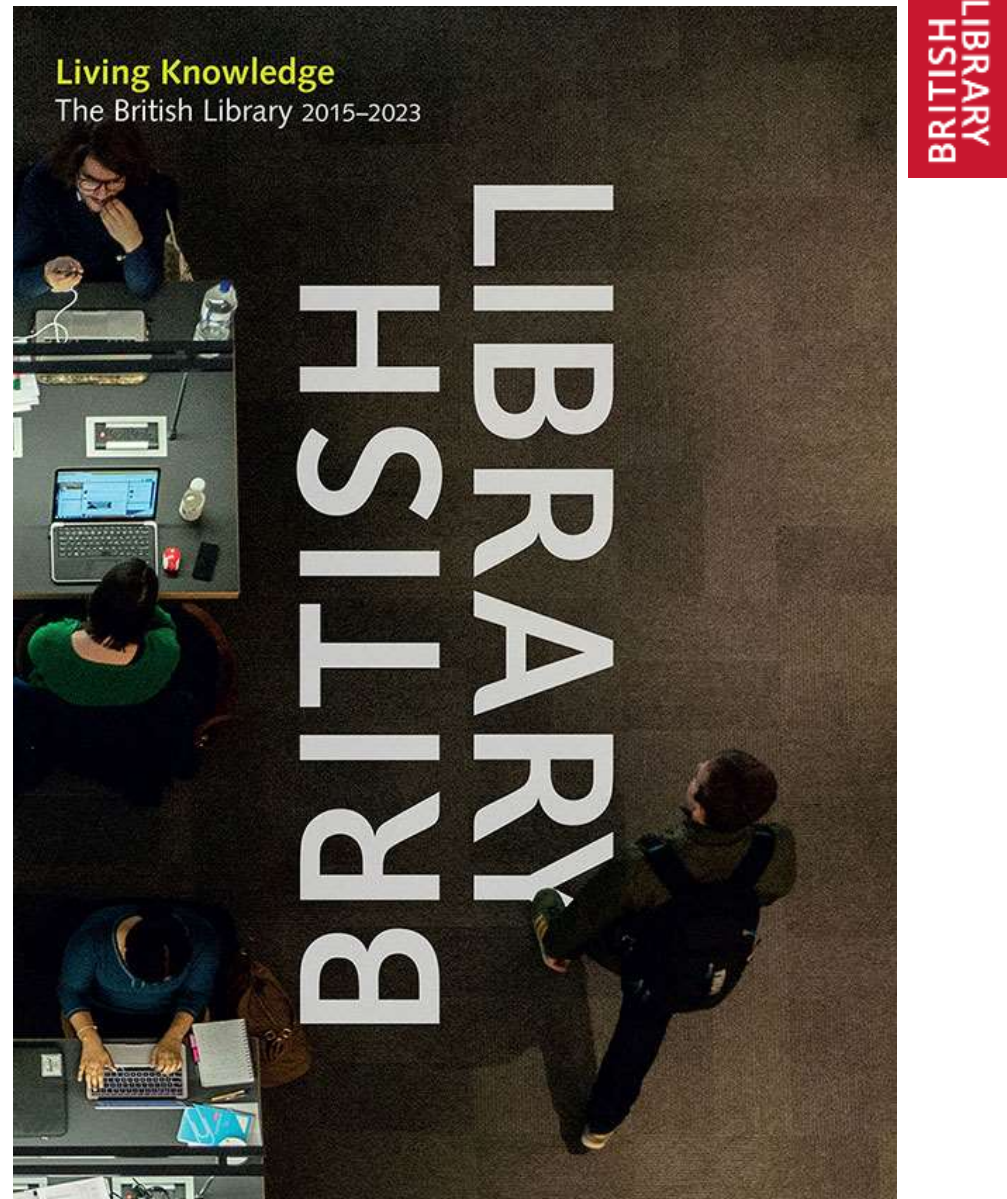

Everything we do contributes to the Purposes



Custodianship

We build, curate and preserve the UK's national collection of published, written and digital content



Research

We support and stimulate research of all kinds



Business

We help businesses to innovate and grow



Culture

We engage everyone with memorable cultural experiences



Learning

We inspire young people and learners of all ages



International

We work with partners around the world to advance knowledge and mutual understanding

Research behaviours are changing..

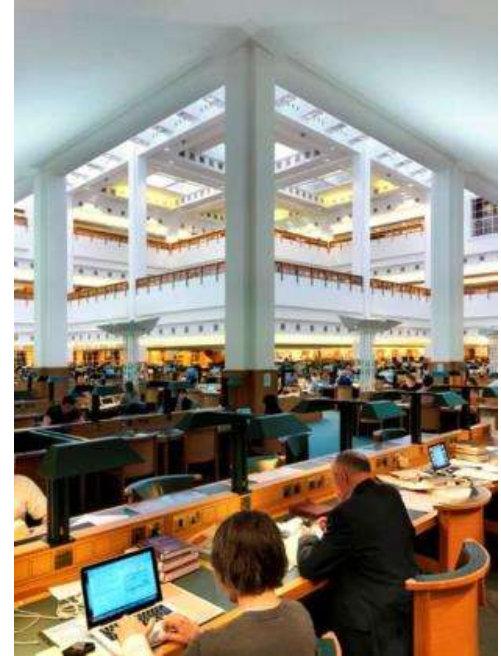

Document Supply Demand Profile

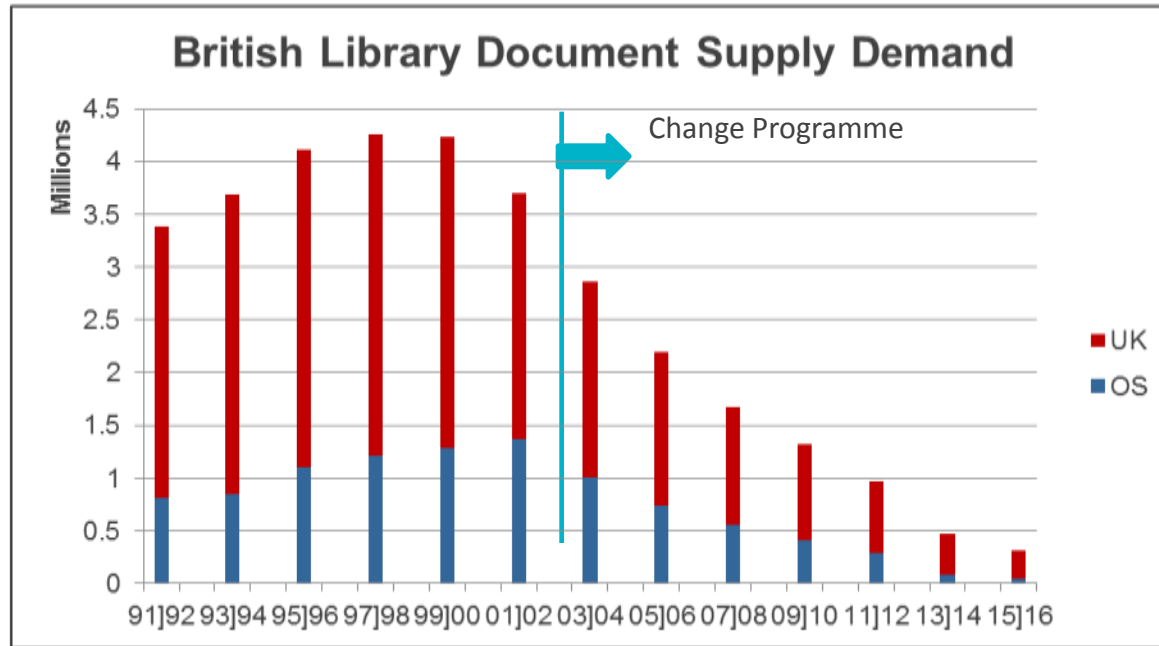

Decline brought on by:-

- Copyright
- Digital innovation (the internet/Google/pay-per-view)
- Competition

More commercial revenue needed to bridge the gap.

Integrated Ordering

Utilising local customer knowledge to create bespoke experiences

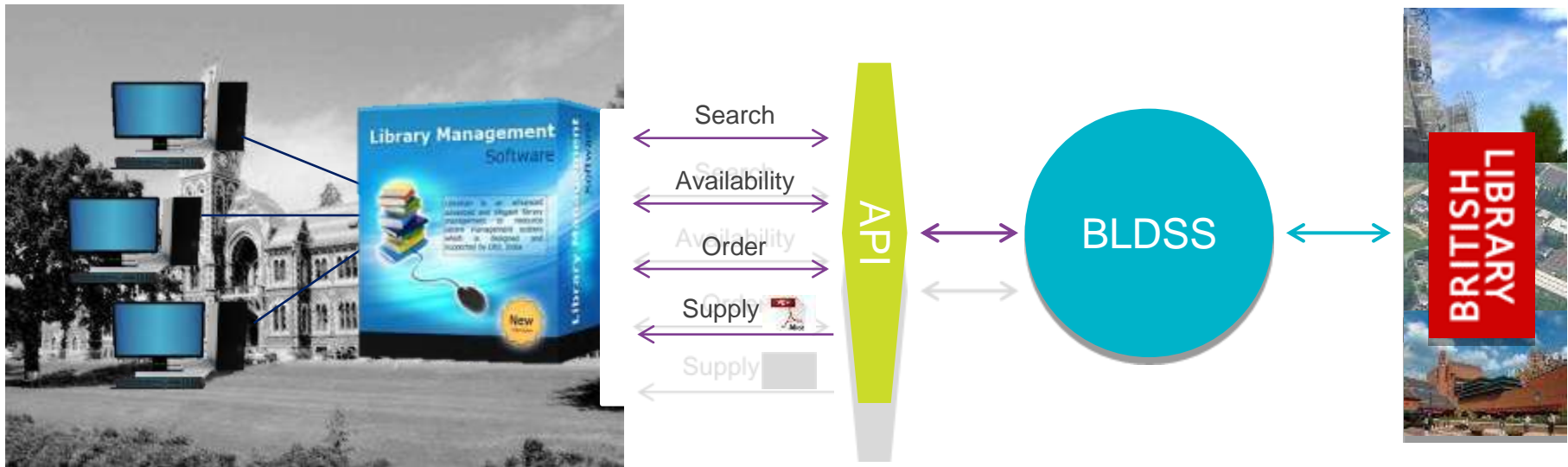

Termination of ARTEmail

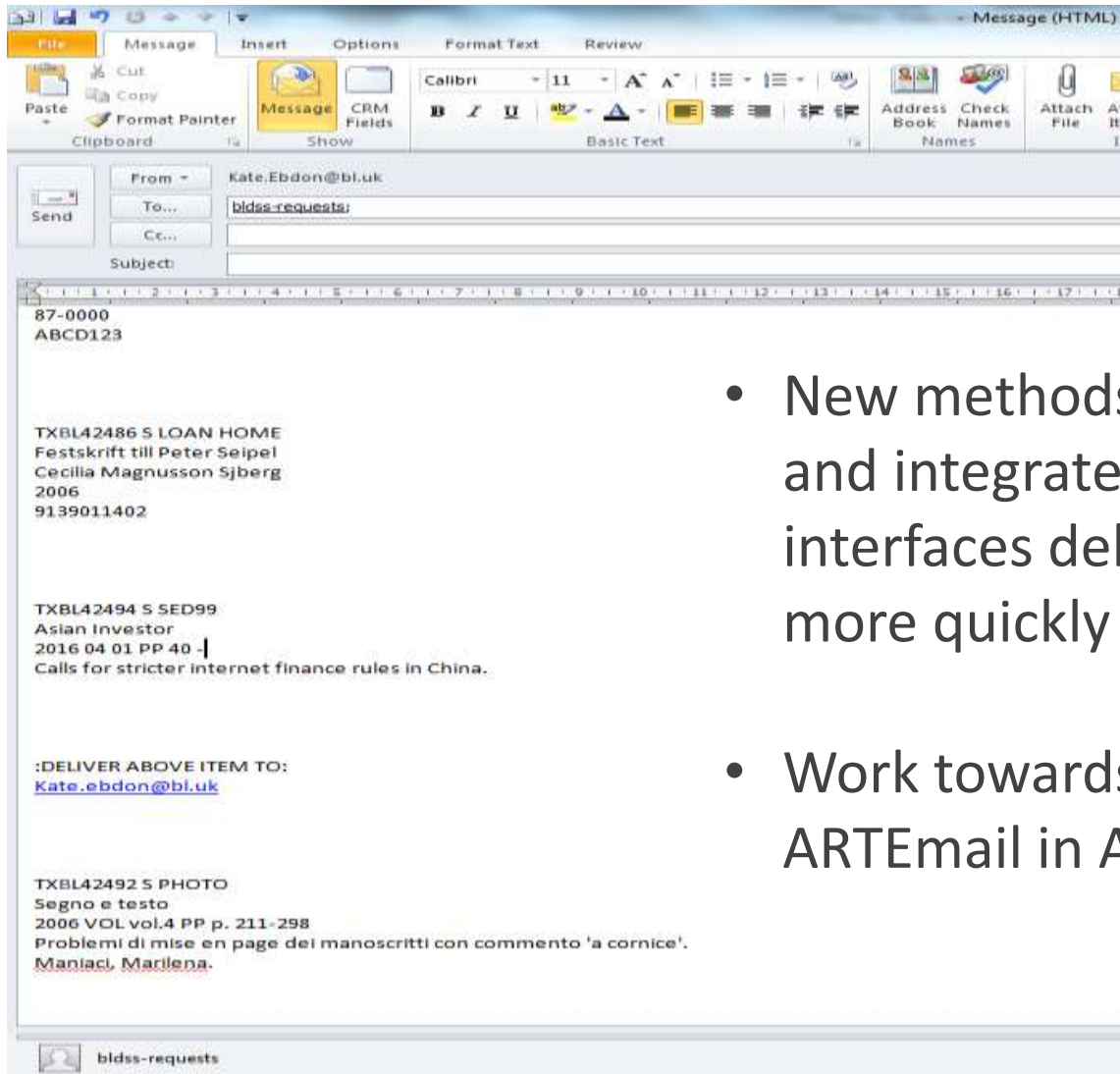

- New methods of resource discovery and integrated online ordering interfaces deliver better information more quickly than ARTEmail
- Work towards withdrawal of ARTEmail in April 2017

Delivery Options



Paper



File Transfer



Encrypted Download



Unencrypted Download



New delivery method – DRM Lite



BRITISH LIBRARY

Catalogues • Collections • Discover • Services • Visiting • About • Information

News

Over 300 On Demand customers have switched to our new DRM solution



Join over 300 organisations and switch to our new digital rights management solution.

Published date: 7 December 2015

Following the highly successful launch of British Library On Demand's delivery solution, [DRM Lite](#), over 300 organisations are now using the service. DRM Lite allows users to download orders without installing third party software. Order can be opened on multiple devices including MacBooks, laptops, tablets and smartphones offering a truly mobile delivery solution.

DRM Lite gives access to secure, encrypted content, ensuring that items are used only as permitted by law and that copyright holder's rights are protected.

All users need is to be registered for On Demand and have the latest version of Adobe Reader installed on their device.



DRM Lite Feedback

Very pleased....now looking to introduce University wide.

Thank you for your efforts to offer a plugin-less delivery option for articles – big improvement



The process of registering and downloading articles is very easy.



Room for some improvements but overall I prefer the system to FileOpen.

I managed to download the article. My thoughts are that it is quite a lot of initial form-filling

Enhanced Higher Education Supply Service (EHES)

- What is EHES?
 - Support reading lists/course packs with UKHE
 - In Partnership with the CLA
 - Works with the CLA Licence
- How does the service work?
 - Outsourced scanning for items held in your collections
 - All scanning
 - Capacity management for busy times
 - Fits in with workflows
 - Copyright Fee Paid scanning for items **not** in your collections
 - Copyright compliant copy for use under CLA licence



Enhanced Higher Education Supply Service (EHSS)

HESS (Higher Education Scanning Service)

Copyright Fee Paid and Outsourcing

DRM Free

Scanned as standard quality using document supply workflow

No OCR

Standard service turnaround

Pay using BL document supply account

EHSS (Enhanced Higher Education Supply Service)

Copyright Fee Paid and Outsourcing

DRM Free

Scanned as high quality using preservation-standard workflow

OCR as standard

48 hour service

Invoice via CLA

Enhanced Higher Education Supply Service (EHSS)

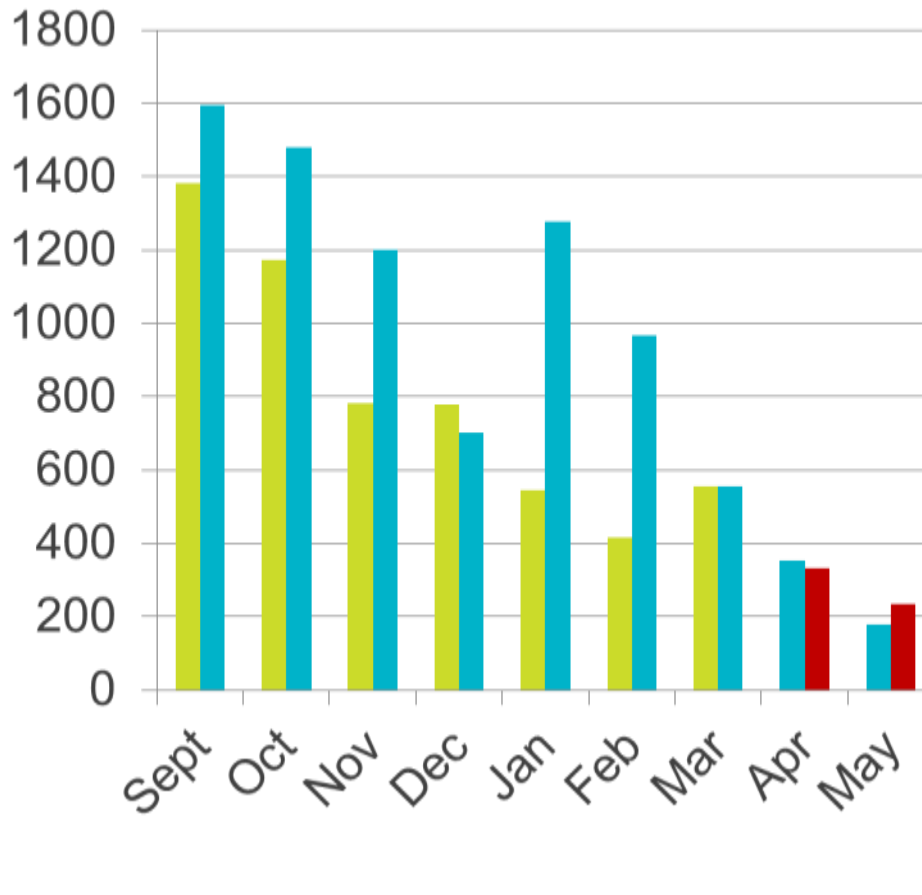

- Increase in use by 35%
- Outsourcing increased by 81%
- Generation of new business

EThOS e-theses online service

Partnership with UK Higher Education to digitise and make accessible UK doctoral theses

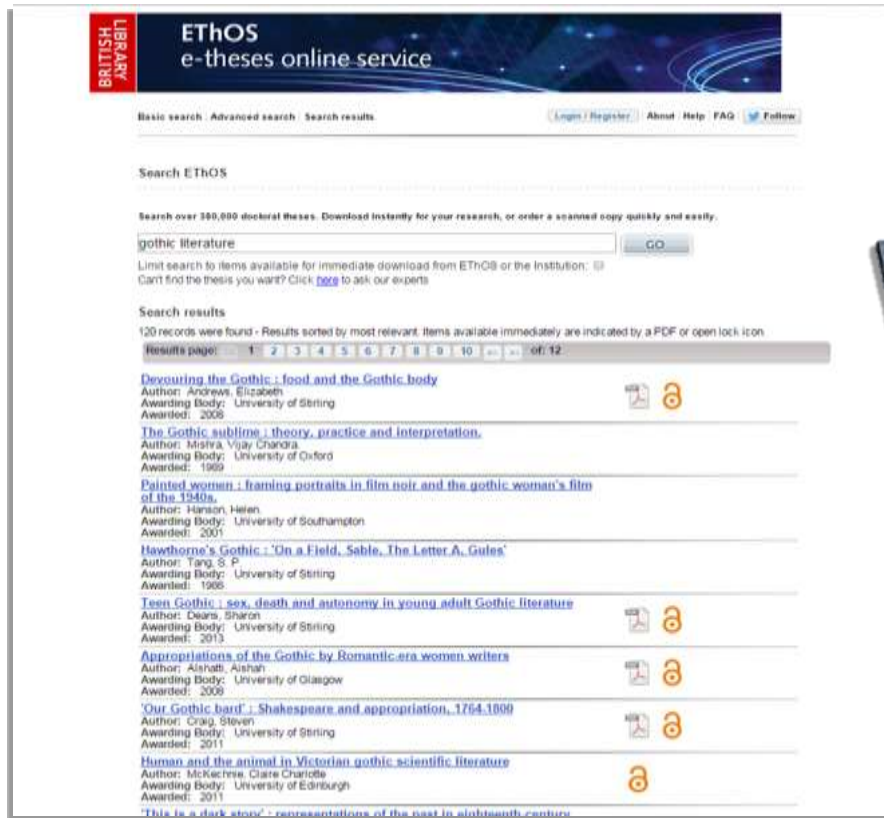

EThOS e-theses online service

- UK PhD theses – <http://ethos.bl.uk>
- 430,000 records
- Free open access to full text theses (170,000)
- Digitisation on demand for print theses
- 132 HE institutions - partnership via MOU

EThOS e-theses online service

Usage increasing year on year

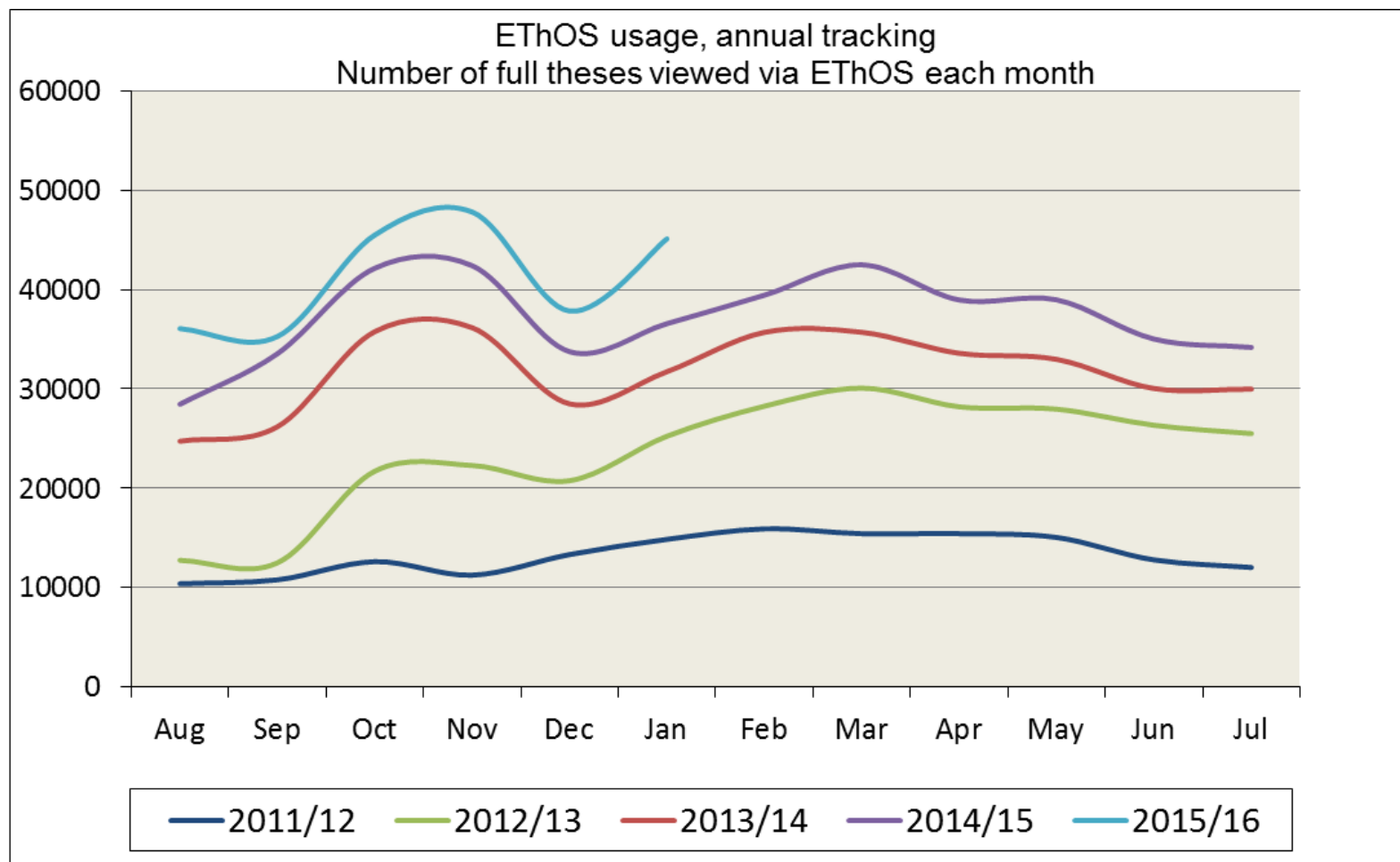

Use this URL to cite or link to this record in ETHOS: <http://ethos.bl.uk/OrderDetails.do?uin=uk.bl.ethos.630167>



Title:	Memory, place and subjectivity : experiments in independent documentary filmmaking		
Author:	Daniels, Jill		
Awarding Body:	University of East London		
Current Institution:	University of East London		
Date of Award:	2014		
Availability of Full Text:	Access through ETHOS:	 Thesis available for immediate download. Please login/register to view download & delivery options.	
	Access through Institution:	 http://roar.uel.ac.uk/3929/	
Abstract:			
<p>The research in this doctoral thesis focuses on the mediation of place, memory and identity in experimental western documentary films and contains film theory and film practice components. It is comprised of the production of two experimental documentary films — Not Reconciled (41 minutes) (2009) and The Border Crossing (47 minutes) (2011) — and a 50,000 word written exegesis that analyses those films and films made by others. The key analytic approaches I deploy are located within the framework of film studies, trauma and memory studies and theories of space, landscape and spectatorship. My aim is to advance a critical understanding of the opportunities and limitations in the cinematic strategies that are available to experimental documentary filmmakers in the mediation of place and memory, including trauma and autobiography. The goal of the experimental film is to offer alternative and different ways of thinking to mainstream films about methods deployed in the mediation of the historical event. The notion of experimental begins and ends with uncertainty rather than verisimilitude. Experimental documentary film aims to open the window of uncertainty a little wider to offer an expanded discussion of the subject of the exploration. My thesis contextualises my discussion of experimental documentary filmmaking by outlining the history and development of independent filmmaking in Britain, with a specific focus on my own development as an independent experimental filmmaker. I argue that where subjects live and where their identities are formed, are central to memory and experience. Place may be represented in experimental documentary films, therefore, not as an adjunct to space or as a support to subjectivities but as a character that is foregrounded and interacts with memory and subjects. Subjectivities, including autobiography through the filmmaker's voice as subject and [iii] filmmaker, are central in my cinematic mediation of memory and traumatic experiences and I devote specific focus to spectatorial engagement with films. I argue that there are difficulties in the mediation of traumatic experiences and that therefore strategies of evocation are needed. I argue that there are similar difficulties in relying on classical linear narrative in articulating memory and narratives of association may be more effective. Finally, I argue in this thesis that an experimental documentary film may deploy disparate filmic strategies such as realism, metaphor, allegory and fiction, yet still remain identifiably a documentary film.</p>			
Supervisor:	Not available	Sponsor:	Not available
Qualification Name:	Thesis (Ph.D.)	Qualification Level:	Doctoral
ETHOS ID:	uk.bl.ethos.630167	DOI:	10.15123/PUB.3929
Share:	     		

EThOS e-theses online service



Digitisation of historic
microfilm collections

Multimedia theses submissions



Worldwide Searches - Home Loan Trial

Case Study 1



Extended Searches

Keyword	BL On Demand Service	Service Offering	Costs
SL	FIFM (Find It For Me)	If we cannot supply from stock we will supply any locations found where you can source the document yourself	British Library Service charge only
BACKUP SW WWS	GIFM (Get It For Me)	If we cannot supply from stock we will source and supply the document for you	Service charge plus the actual cost of the item from the 3 rd party supplier.

Worldwide Searches - Home Loan Trial



- Good delivery times
- No issues with accuracy and quality
- Value for money



- Home Loan restrictions impractical



Worldwide Searches - Home Loan Trial

Worldwide Searches

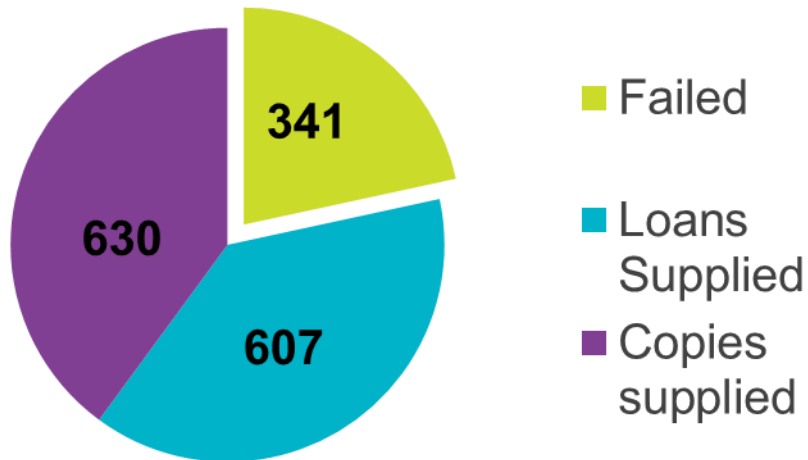

Fulfilment rate 78%

Home Loan Trial

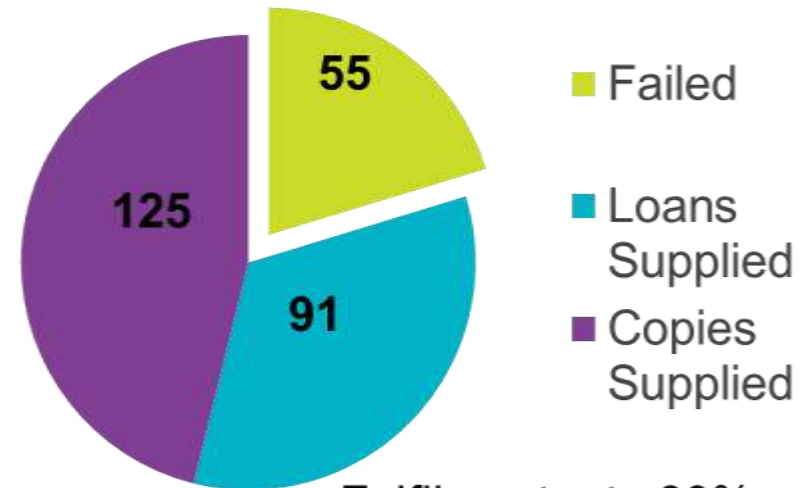

Fulfilment rate 80%

NEXT STEPS

- Open to all customers and embed as BAU
- Look into feasibility of direct delivery
- Review Home Loan restriction for all BL material

Focus Groups



Boston Spa
Wednesday 21 September



London
October



kate.ebdon@bl.uk

The BL National Print Hub

Case study 2



National Newspaper Building, Boston Spa

- 24m high bay storage void
- Low oxygen, temperature and humidity
- Automated retrieval by cranes and conveyors

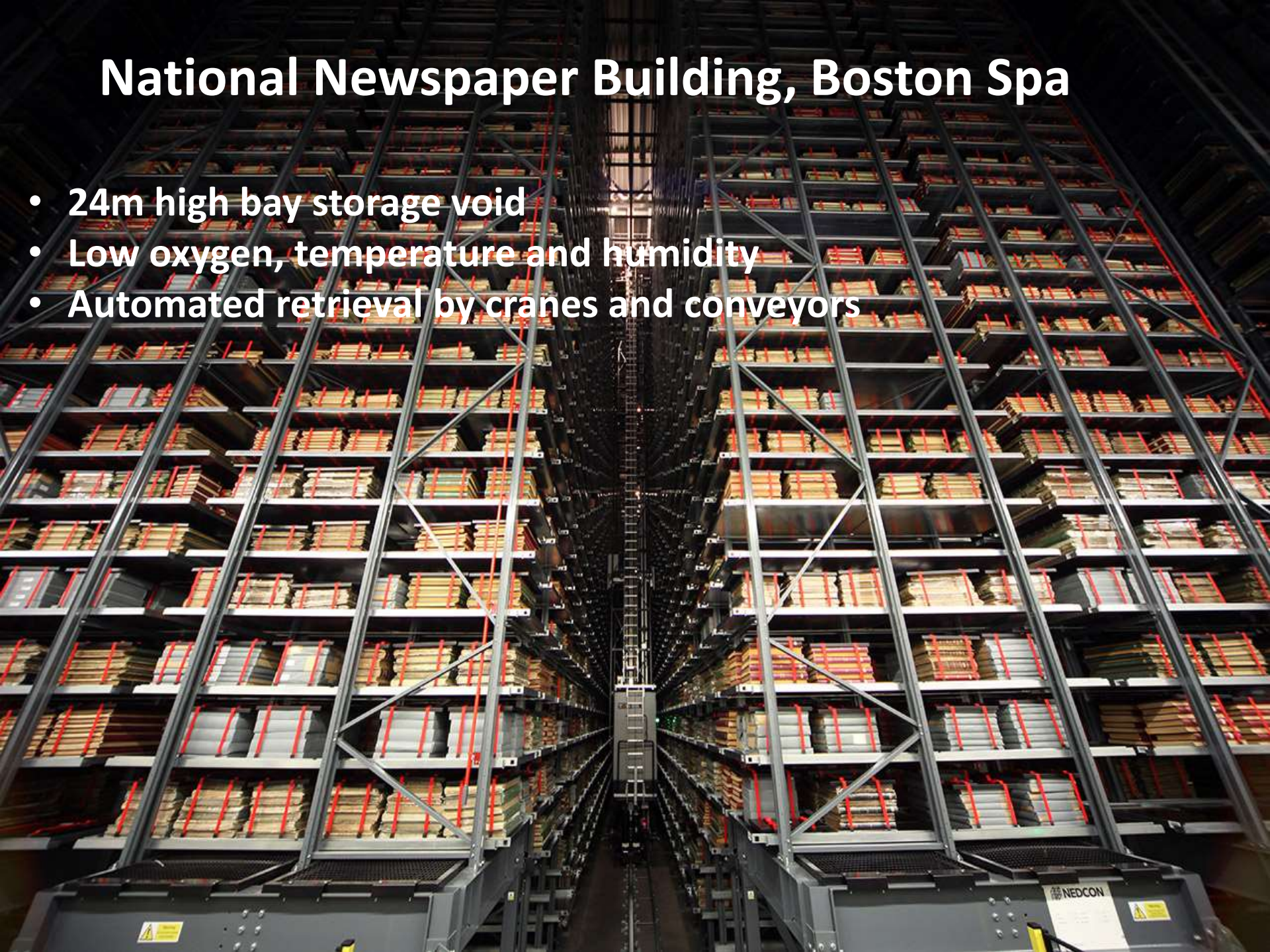

Location perfect for national print distribution



BSP ideally placed for physical distribution.

BSP BL operations highly skilled in handling, tracking, security and delivery (based on Document Supply Operations)



Currently the 60 acre site has only 21% building occupancy; 3 stores are environmentally controlled, 2 of which are automated, high density stores.

Partnership – BL and UK Higher Education

“UK Research Reserve (UKRR)



INDEPENDENT REPORT

..... speculated that, if all libraries were able to dispose of their holdings that duplicated those held by the BL, as much as £103 million might be saved in the capital construction costs of storage space in future.

WHAT IS IT?

- A partnership (BL and UK HE) approach for long-term retention, preservation and access to **low use print research journals**.
- Delivers capital savings, operational savings and space (c100 linear km).
- Protecting and preserving national research collections.
- Original accessible (BL can deliver within 24 hrs).

Other possibilities..

OTHER MUSEUMS, LIBRARIES and ARCHIVES

- Significant interest – National History Museum, Science Museum, British Museum etc.
- Initial Business Case submitted to HM Treasury – investigating commercial partner to share investment.

OTHER POTENTIAL PARTNERS

- National Health Service (NHS)
- Central / Local Government
- Higher Education – Monographs
- (Commercial)

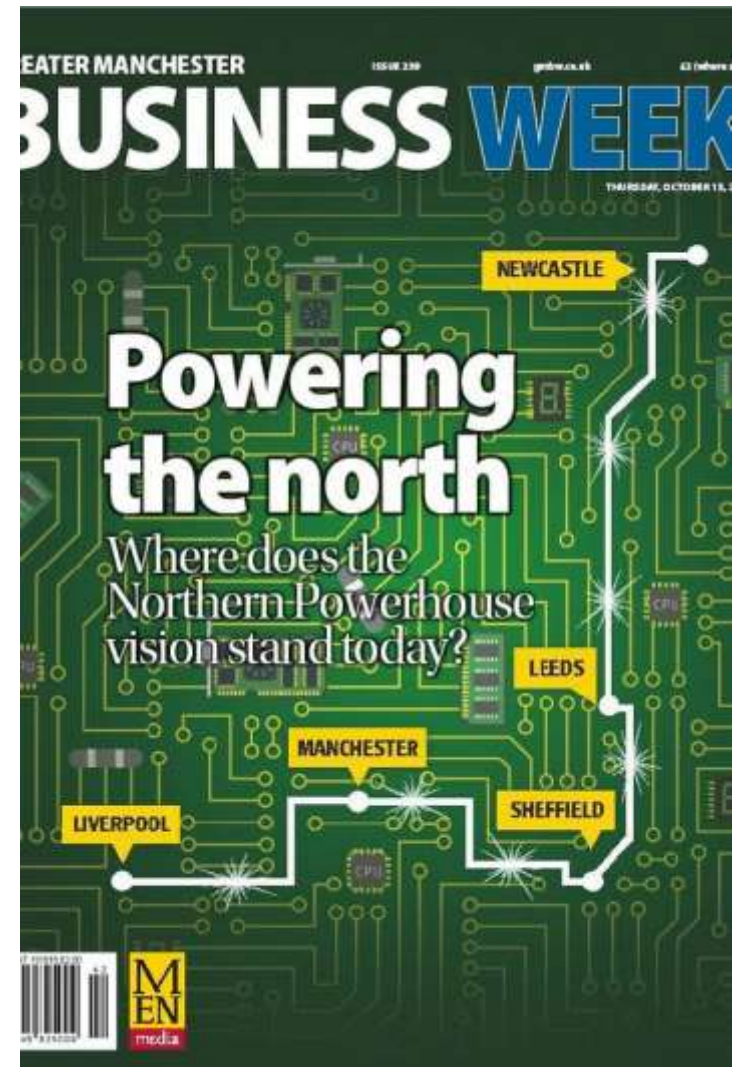

The vision..

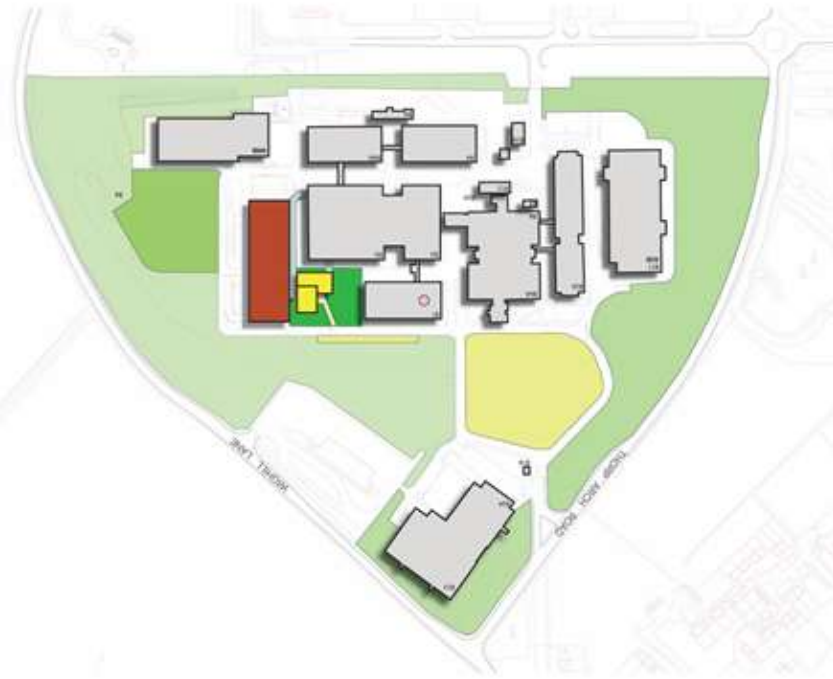

- A collaborative print storage repository – with access provision.
- Joint funded through public and private investment.
- Additional services – digitisation, conservation, cataloguing etc.

Thank you